

PROBLEMS OR QUESTIONS 254-968-9263
BOWMAN@TARLETON.EDU
FOR IMMEDIATE ASSISTANCE CALL 254-968-9265 CONTROL CENTER

DO NOT ENTER CONSTRUCTION FENCE:
HARD HAT AREA, CONSTRUCTION WORKERS ONLY

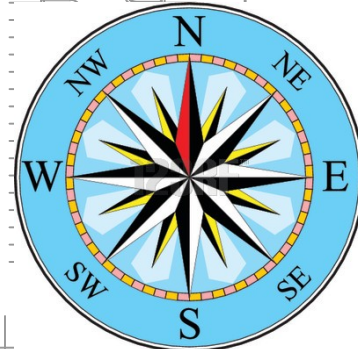

- RED LINE AROUND AREA INDICATES CONSTRUCTION FENCE:
Hard Hat Area/Construction Workers Only
- RED CIRCLE INDICATES POTHOLE:
Hard Hat Area/Construction Workers Only
- SMALL RED SQUARE INDICATES BARRICADE:
Hard Hat Area/Construction Workers Only
- BLUE LINE INDICATES TEMPORARY PATHWAY

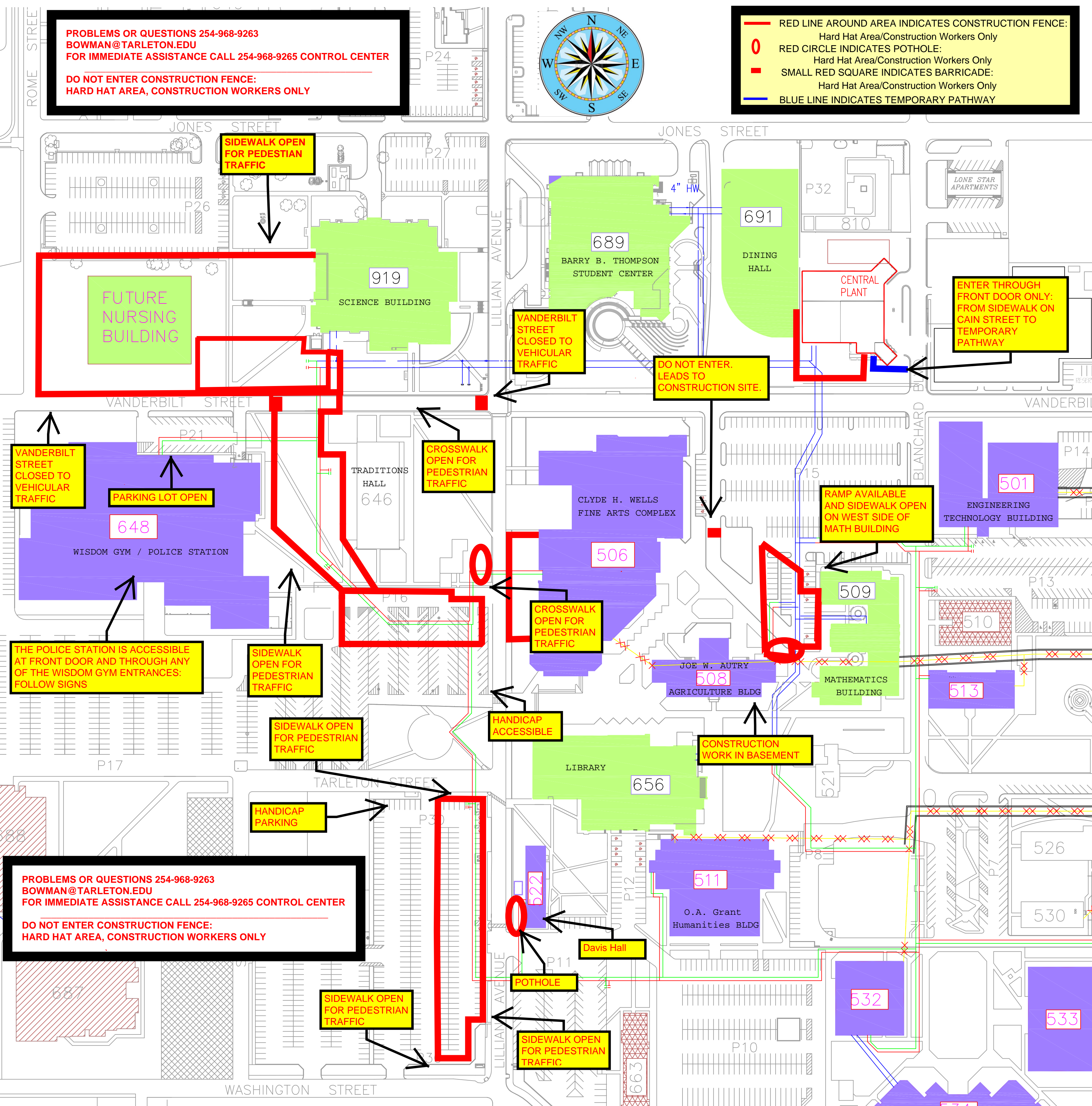

SIDEWALK OPEN FOR PEDESTRIAN TRAFFIC

VANDERBILT STREET CLOSED TO VEHICULAR TRAFFIC

DO NOT ENTER. LEADS TO CONSTRUCTION SITE.

ENTER THROUGH FRONT DOOR ONLY: FROM SIDEWALK ON CAIN STREET TO TEMPORARY PATHWAY

VANDERBILT STREET CLOSED TO VEHICULAR TRAFFIC

PARKING LOT OPEN

CROSSWALK OPEN FOR PEDESTRIAN TRAFFIC

RAMP AVAILABLE AND SIDEWALK OPEN ON WEST SIDE OF MATH BUILDING

THE POLICE STATION IS ACCESSIBLE AT FRONT DOOR AND THROUGH ANY OF THE WISDOM GYM ENTRANCES: FOLLOW SIGNS

SIDEWALK OPEN FOR PEDESTRIAN TRAFFIC

CROSSWALK OPEN FOR PEDESTRIAN TRAFFIC

HANDICAP ACCESSIBLE

CONSTRUCTION WORK IN BASEMENT

SIDEWALK OPEN FOR PEDESTRIAN TRAFFIC

HANDICAP PARKING

PROBLEMS OR QUESTIONS 254-968-9263
BOWMAN@TARLETON.EDU
FOR IMMEDIATE ASSISTANCE CALL 254-968-9265 CONTROL CENTER
DO NOT ENTER CONSTRUCTION FENCE:
HARD HAT AREA, CONSTRUCTION WORKERS ONLY

POTHOLE

SIDEWALK OPEN FOR PEDESTRIAN TRAFFIC

SIDEWALK OPEN FOR PEDESTRIAN TRAFFIC

Davis Hall